

ADDENDUM TWO, AUGUST 8, 2018

This addendum is provided for clarification only. No separate pricing is required.

Exhibit E in original Bid Docs and as amended in Addendum 1 is updated to include the following additional information.

3E Thermal has provided the following supplemental guidance as to the objectives and best methods for achieving the insulation values they will expect to make roof insulation work reimbursable. The following article from Green Building Advisor provides a description and sample drawing detail (below) of the method they will require. <http://www.greenbuildingadvisor.com/cad/detail/exterior-roof-insulation-retrofit-cathedral-ceiling-rigid-foam>

As an example, assuming that the roof cavity depth is 7” (the apparent depth based upon previous work photographs) we would be able to achieve an R-42 to R-49 (depending on the manufactures rating) by filling the cavities with SPF and adding 3” of rigid foam above, adding approximately R-18 to R-22 depending on the manufacturers rating for the product(s) used.

ADDENDUM TWO, AUGUST 8, 2018

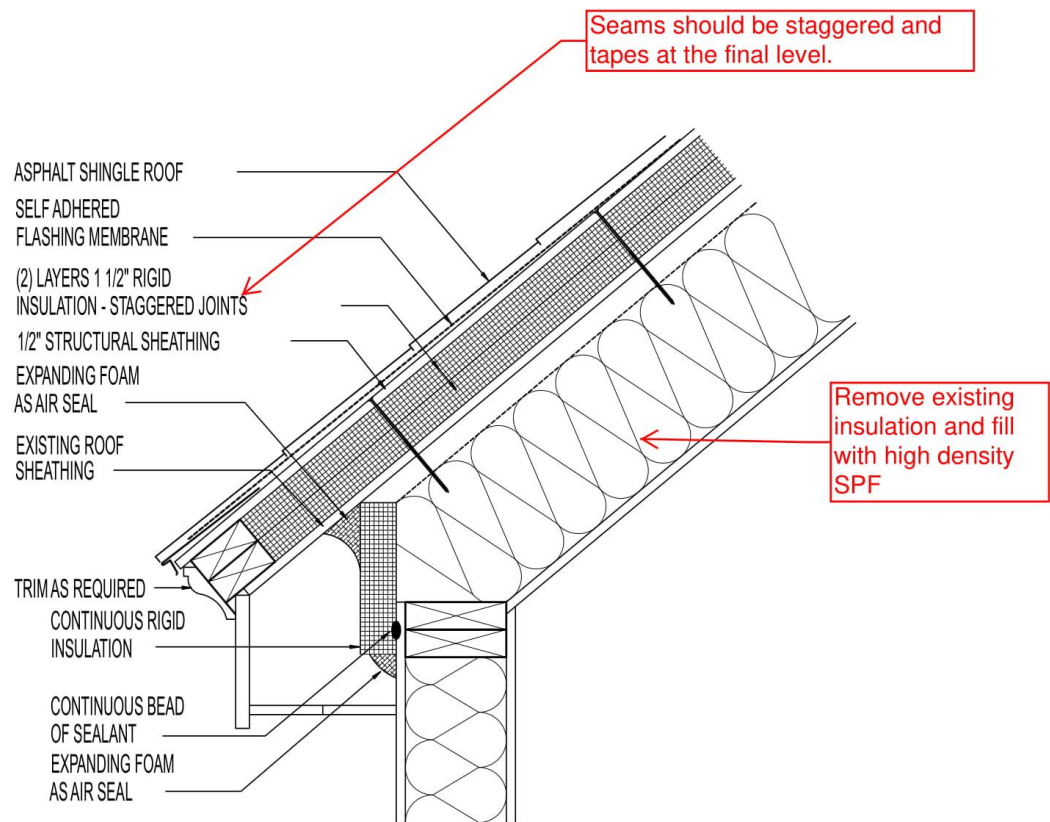

EXTERIOR INSULATION AT ROOF RETROFIT // 3" RIGID INSULATION		9-00800
GreenBuildingAdvisor.com © BuildingGreen LLC 2008	Scale: 1 1/2" = 1'-0"	